

# *Callaghans*

Independent Estate Agents, Surveyors, Valuers and Mortgage Brokers

**13 West View Road,**  
**Manchester, M22 4LU**



**£250,000**

**Modern End Terrace  
Three Bedrooms  
Gardens and Driveway  
Spacious Dining Kitchen  
Freehold  
Council Band A**

Callaghans Estate Agents  
46 Church Road, Gatley, SK8 4NQ  
Telephone: 0161 491 4000, Fax: 0161 491 55 44  
Website: [www.callaghansltd.com](http://www.callaghansltd.com) Email: [admin@callaghansltd.com](mailto:admin@callaghansltd.com)

**This modern end-of-terrace home is a perfect blend of comfort and style, ideal for a growing family. The expansive lounge is designed for relaxation and social gatherings, seamlessly extending into a well-maintained garden through elegant patio doors. The heart of the home is the spacious family dining kitchen, equipped with modern amenities to cater to culinary adventures and family meals. The contemporary bathroom and three cozy bedrooms offer private spaces for rest and rejuvenation. Outside, the property boasts both front and rear gardens, providing ample space for outdoor activities and gardening enthusiasts. A driveway adds the convenience of off-street parking. This property is not just a house, but a warm and inviting home waiting to be filled with new memories.**

**Lounge** 18' 10" x 11' 2" (5.74m x 3.41m)

**Kitchen** 18' 10" x 11' 4" (5.74m x 3.45m)

**Family Bathroom** 5' 5" x 5' 5" (1.66m x 1.66m)

**Bedroom One** 8' 6" x 13' 1" (2.6m x 3.98m)

**Bedroom Two** 11' 6" x 10' 11" (3.5m x 3.33m)

**Bedroom Three** 7' 6" x 8' 5" (2.29m x 2.56m)

GROUND FLOOR  
423 sq.ft. (39.3 sq.m.) approx.

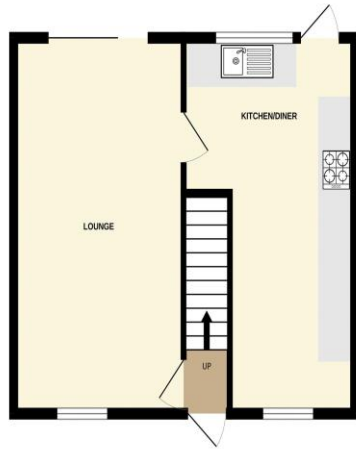

1ST FLOOR  
390 sq.ft. (36.2 sq.m.) approx.

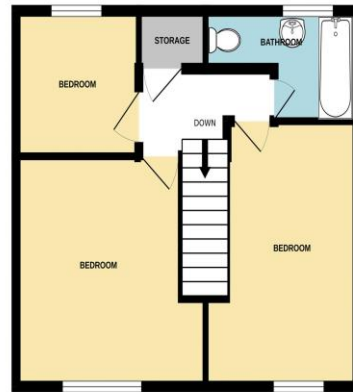

TOTAL FLOOR AREA: 813 sq.ft. (75.5 sq.m.) approx.

Whilst every attempt has been made to ensure the accuracy of the floorplan contained here, measurements of doors, windows, rooms and any other items are approximate and no responsibility is taken for any error, omission or mis-statement. This plan is for illustrative purposes only and should be used as such by any prospective purchaser. The services, systems and appliances shown have not been tested and no guarantee as to their operability or efficiency can be given.  
Made with Hexpix ©2024

**Disclaimer:**

These particulars, whilst believed to be accurate are set out as a general guideline only or guidance and do not constitute any part of an offer or contract. Intending purchasers should not rely on them as statements of representation or fact, but must satisfy themselves by inspection or otherwise as to their accuracy. Please note that we have not tested any apparatus, equipment, fixtures, fittings or services, including gas central heating and so cannot verify they are in working order or fit for their purpose. Further more solicitors should confirm movable items described in the sales particulars are, in fact included in the sale since circumstances do change during marketing or negotiations. Although we try to ensure accuracy, measurements used in this brochure may be approximate. Therefore if intending purchasers need accurate measurements to order carpeting or to ensure existing furniture will fit, they should take such measurements themselves. **YOUR HOME IS AT RISK IF YOU DO NOT KEEP UP REPAYMENTS ON A MORTGAGE OR OTHER LOAN SECURED ON IT**